

**PAUL
ROBERT**

DEVELOPMENTS
LIMITED

DROVERS MEAD

Moreton Hall, Bury St Edmunds



- FIVE BEDROOMS
(Two with En Suite)
- DRAWING ROOM
- DINING ROOM
- LUXURY EQUIPPED
& FITTED KITCHEN
- CONSERVATORY
STYLE BREAKFAST
AREA
- UTILITY ROOM
- FAMILY BATHROOM
- DOUBLE GARAGE
- 8'9" CEILING HEIGHT
(Ground & 1st Floors)

A choice of four Architect designed individual luxury homes in period style, offering very spacious five bedroom family accommodation on good-sized plots in a most pleasant location in this popular part of Bury St Edmunds.

LACY SCOTT AND KNIGHT

10 RISBYGATE STREET, BURY ST EDMUNDS, SUFFOLK IP33 3AA

Tel: (01284) 748600 Fax: (01284) 748610

email: info@lsk.co.uk • internet: www.lsk.co.uk

PAUL ROBERT

DEVELOPMENTS LIMITED

This locally established small company has gained an enviable reputation since becoming established in 1998 for building homes of very high quality, and in 2000 won an award presented by The Bury St Edmunds Society.

Each project has the benefit of the personal involvement and direction of the Managing Director Paul Warner, ensuring each home is completed to the exacting standards required.

Each Home Carries a 10 Year NHBC Certificate.

DROVERS MEAD Floor Plans

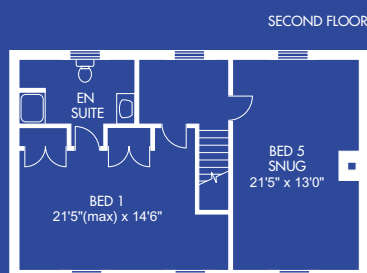
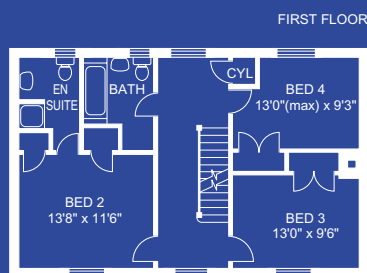
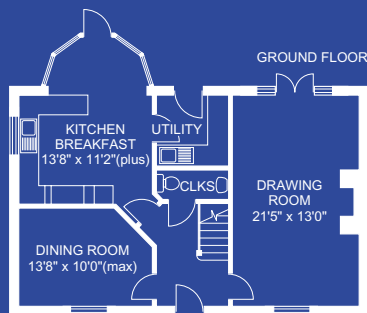

Site Location

DROVERS MEAD on Moreton Hall has become a by-word in Bury St Edmunds for new homes of quality and distinction and is justifiably regarded as amongst the most desirable places to live in the Borough.

Paul Robert Developments are one of three developers building to their own distinctive styles and offer these four homes in perhaps one of the most pleasant locations on the site.

Drovers Mead offers an ideal family environment within walking and cycling distance to the historic centre of Bury St Edmunds and within a few minutes distance to local schooling, surgery, Sainsbury Superstore, Retail Park and A14. The town offers wide and acclaimed shopping and educational facilities, leisure and cultural pursuits and there is a commuter rail-link service operating from the station to Liverpool Street.

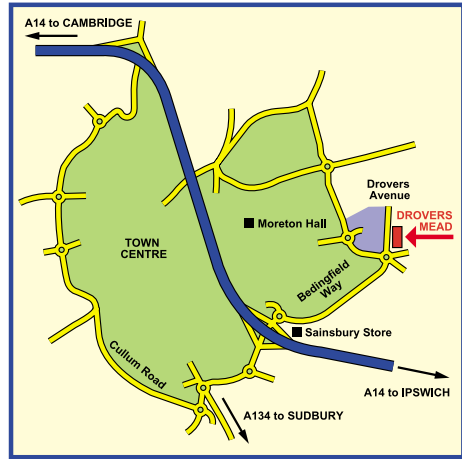

- **FULL GAS CENTRAL HEATING.**
- **DOUBLE GLAZED WINDOWS - With Low "E" Glass.**
- **LUXURY EQUIPPED KITCHEN TO INCLUDE:**
Cooking Range, Integrated Fridge / Freezer & Dishwasher.
- **HIGH QUALITY SANITARY WARE & HALF TILED WALLS.**
- **PICTURE RAIL TO MAIN ROOMS.**

These particulars do not constitute part of an offer or contract. Messrs. Lacy Scott and Knight for themselves and for the Vendor do not give or make any warranty or representation whatever in relation to this property. Whilst care and responsibility has been taken in the preparation of these particulars they should not be relied upon as a statement or representation of fact, we have not carried out a detailed survey, nor tested the services, appliances and specific fittings.